

Take Control.  
**ION**  
*Technologies*



# SEF100-SEF200

Heavy Duty Sewage Pump

- High capacity pump
- Commercial sewage
- Septic tank effluent
- Dewatering
- High head sump



37 Forestwood Dr., Romeoville, IL 60446 [www.ionproducts.net](http://www.ionproducts.net) [815] 886-9200

# SEF100-SEF200

Heavy Duty Sewage Pump

## System Specifications

- Typical Applications
- High capacity pump
  - Commercial sewage
  - Septic tank effluent
  - Dewatering
  - High head sump

Maximum Capacity	
• SEF100	190 GPM @ 10'
• SEF200	245 GPM @ 10'
Maximum Head	
• SEF100	Up to 37'
• SEF200	Up to 49'
Electrical Data	
• SEF100M-21	230 V, 1 Ø, 10.8 FLA, 60 Hz
• SEF100M-23	230 V, 3 Ø, 8.0 FLA, 60 Hz
• SEF100M-03	208 V, 3 Ø, 8.5 FLA, 60 Hz
• SEF100M-43	460 V, 3 Ø, 4.0 FLA, 60 Hz
• SEF200M-21	230 V, 1 Ø, 16.7 FLA, 60 Hz
• SEF200M-23	230 V, 3 Ø, 11.0 FLA, 60 Hz
• SEF200M-03	208 V, 3 Ø, 11.5 FLA, 60 Hz
• SEF200M-43	460 V, 3 Ø, 5.5 FLA, 60 Hz
Motor Data	
	1 & 2 HP, 1750 RPM
Intermittent Liquid Temperature	
	104° F
Recommended Minimum Basin Size	
	18" x 30"
Manual Operation	
	M: Manual
Materials of Construction	
	Cast iron
Impeller	
	Cast iron, vortex
Power Cord	
• SEF100M1Ø-20	14AWG/3C-20'
• SEF200M1Ø-20	12AWG/3C-20'
• SEF100M 3Ø-20	14AWG/4C-20'
• SEF200M 3Ø-20	14AWG/4C-20'
Discharge	
	2" or 3" NPT opt.
Solids Handling	
	2"

## Pump Dimensions

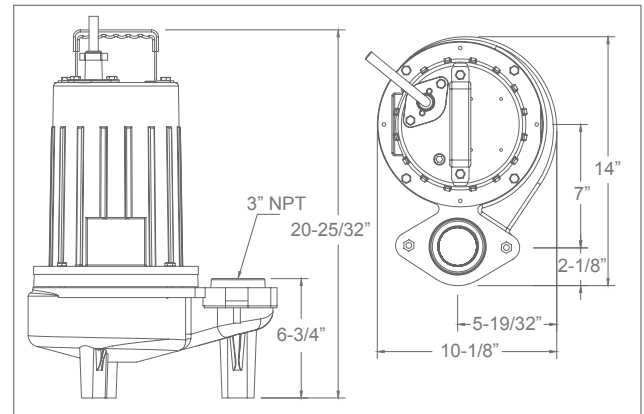

## Pump Performance

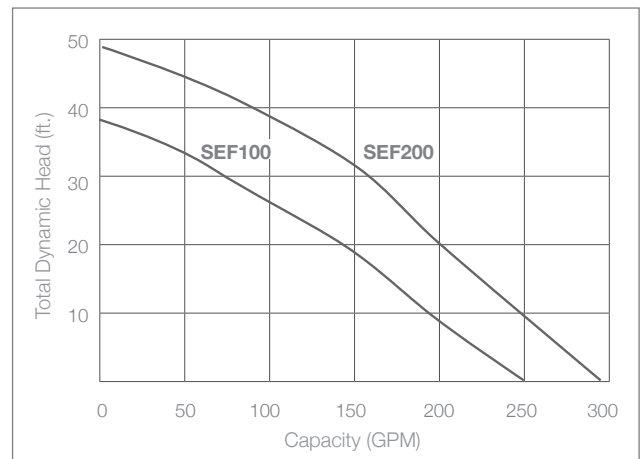

## Features

- Carbon ceramic mechanical seal
- Automatic reset thermal overload for maximum protection
- Lower single-row ball-bearing construction
- 3 year warranty